

FP150



Elevated Runway Edge and Threshold/Runway End Light



Compliances:

- ICAO: Annex 14 - Volume I
- FAA: L-862 AC150/ 5345-46 (Current Edition)
- IEC: TS 61827
- NATO: STANAG 3316

Manual:

- Instruction manual **UT-MT-0046**

Applications:

- The FP150 is a **high intensity, bidirectional, elevated runway edge** light that can be used for any category I, II and III ICAO and military runways.
- The FP150 does **double duty as a threshold/runway end** ICAO and STANAG light for instrument runways.
- These fixtures are designed to be powered by **series circuits**.
- The field installation shall be in compliance with the requirements of ICAO - Annex 14 or STANAG 3316 Specs.

Features:

- Die-cast aluminium body complete with PK30d lamp support.
- The optical assembly consists of two Fresnel lenses mounted one inside the other. The outer lens, heat resistant clear glass, has the external surface completely smooth for easy maintenance. The inner lens is generally one clear glass 360° piece; if required, it can consist of two 180° pieces, one or both coloured. The removal of both the lenses is quick and easy. Customized lens gaskets avoids the use of sealing. To provide a unidirectional light output an aluminium screen can be mounted between the two lenses.
- the body is balanced on a die-cast aluminium column and fixed to it by means of four levelling screws. The column is provided with a breakable groove, meeting FAA Specs, with lower 2"-11 Gas male thread.
- No optical adjustment is required after the replacement of lamp or lenses.
- The fixture is equipped with a power supply cable lead equipped with FAA L-823 plug.
- A daymarker cone, which can equip the light without modification, is available on request.
- A suitable screw is provided for grounding purposes.

Luminous Source:

- 150 W tungsten-halogen, 6.6 A, PK 30/d base, with male faston cable leads, 1000 hour rated life. Lamp replacement is quick and easy without any tool.

Power Supply:

- From 150W up to 300W series transformer.

Installation:

- The fixture can be installed on a pipe elbow or on a baseplate (with 2"-11 Gas thread). On request, a suitable optical device is supplied for precise levelling and alignment of the light.

How to order:

F	P	1	5	0	-	S	-	C	Y	-	1	5	0	-	
Basic P/N:					Compliance:		Colour (Side SX)/Colour (Side DX)*:			Lamp:					
S= ICAO 45m Runway Edge and Instrument Runways Threshold/End					I = ICAO 60m Runway Edge		C = Clear			150 = 1x150W 6.6A PK 30/d					
F= FAA Runway Edge					G = Green		Y = Yellow			Options:					
					R = Red		X = Screened			C = Daymarker Cone					

* Colour Selection

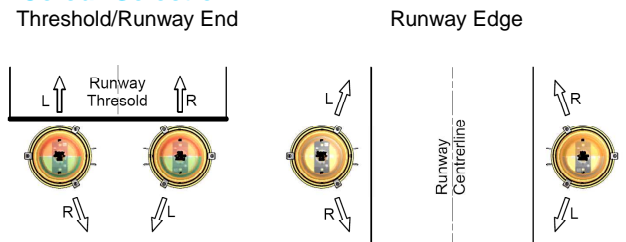

Dati tecnici:

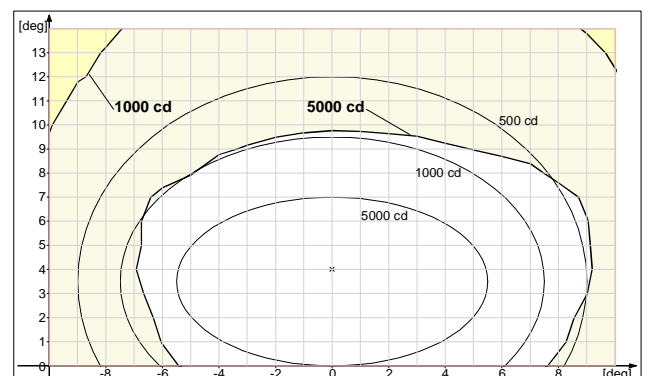

ICAO Fig. A2-9 - 45m Runway Edge (clear light)

Installation:

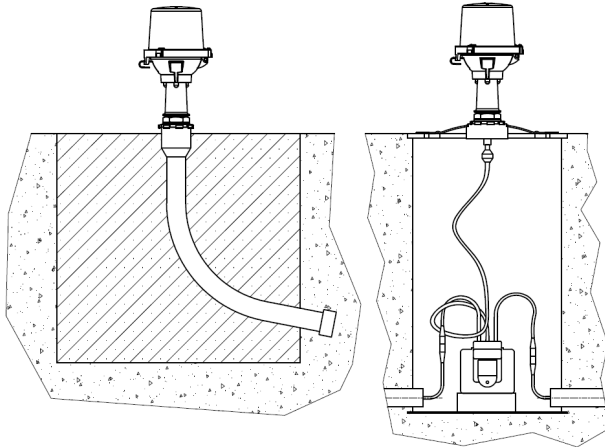

On pipe elbow

On FAA L-867 base
and baseplate

Accessories:

[P/N]	Description
013.0010	Set of two nylon rings for receptacle support inside pipe elbow
013.0008	Galvanized steel pipe elbow with upper threaded end only (2" - 11 GAS thread)
315.3210	Galvanized steel pipe elbow with both threaded ends (2" - 11 GAS thread)
315.1228	Base L-867, Class IA, Size B, 24" Deep
315.1062	Baseplate for L-867 base with gasket and cable clamp (2"-11 GAS thread)
332.3250	Ring for levelling and alignment
332.4401	Levelling and alignment optical device

For any information about isolating transformers and connectors, please see the specific catalogue pages

Overall Dimensions:

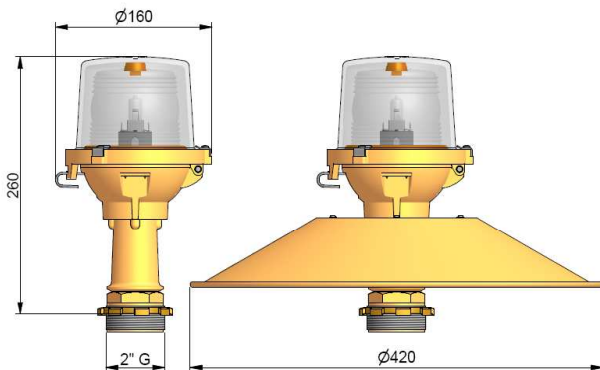

Renewal Parts:

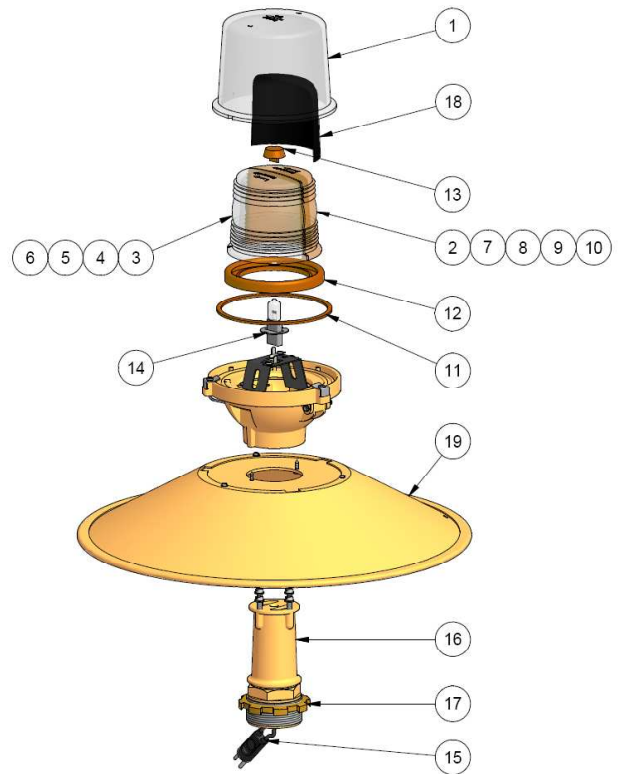

[N]	[P/N]	Description
1	810.3016	Clear outer lens
2	810.3017	360° clear inner lens
3	810.3018	180° clear left inner lens
4	810.3020	180° yellow left inner lens
5	810.3022	180° red left inner lens
6	810.3034	180° green left inner lens
7	810.3019	180° clear right inner lens
8	810.3021	180° yellow right inner lens
9	810.3023	180° red right inner lens
10	810.3035	180° green right inner lens
11	325.0190	Gasket for outer lens
12	325.0200	Gasket for inner lens
13	325.0000	Upper block for inner lens
14	760.3170	150W tungsten-halogen lamp, 6.6A, PK 30/d base
15	323.2220	L-823 two-pole plug with cable leads
16	155.8020	Breakable column with 2"-11 Gas thread and groove, complete with ring nut and hardware
17	786.1001	Ring nut (2"-11 Gas thread) for breakable column
18	321.7020	180° screen opaque
19	155.9020	Daymarker cone
	155.9000	Body with lens ring

Shipping Weights and Volumes:

	Light (without cone)	Cone (one piece)
Weight	2.3 kg	0.6 kg
Volume	0.009 m ³	0.003 m ³



Via 2 Agosto 1980, 11 40016 - S. GIORGIO DI PIANO - BOLOGNA (ITALY)
tel: +39 051 6656611 - fax: +39 051 6650099
e-mail: ocem@ocem.com - web: www.ocem.com