



LITC

LED INSET TAXIWAY CENTRELINE, STOP BAR AND INTERMEDIATE HOLDING POSITION LIGHT



COMPLIANCES

ICAO: Annex 14 - Volume I Fig. A2-12-13-14-15-16
EASA: CS-ADR-DSN Fig. U-16, 17, 18, 19, 20
FAA: L-852A-B-C-D-J-K(L) AC150/5345-46 and EB No.67
IEC: TS 61827
NATO: STANAG 3316
CAA: CAP 168
TCCA: TP312

APPLICATIONS

Taxiway centreline, stopbar and intermediate holding positions for ICAO CAT I,II and III, FAA and military taxiway

BENEFITS

- 60000 hours LED rated life at full intensity, but over 100000 hours in field operating conditions
- In new installation, LED lights mean lower loads, lower size of CCRs and transformers, thus low life cycle costs
- The light output is variable like a traditional halogen lamp, as indicated by the FAA "Engineering Briefing No.67"
- Colour emitted directly by LEDs: absence of coloured filters ensures no energy losses and no colour shifts
- Fully compatible with existing AFL infrastructure*
- Designed with simplicity allowing longer maintenance intervals and fewer spare parts
- No use of sealant to fix the prisms in the dome thanks to customized gaskets, making their replacement quick and easy
- No optical adjustment after LED module or prism replacement
- Valve for watertightness test after overhaul
- Operating with any topology of CCRs designed in compliance with IEC or FAA requirements

* For monitored fixtures, isolation transformer max size: 200VA

PERFORMANCES

- The electronic is strong-built and highly resistant to shock and vibration
- Automatic adaptation to the frequency of the supply current
- A surge protection device is provided in the electronics as required by the FAA "Engineering Briefing No.67"
- Immediate detection of an internal fault
- 6.35 mm protrusion strongly reduces vibrations to aircrafts and to light itself, increasing its lifetime
- Dome smooth outer profile makes the light less sensitive to snowplough blades
- Bidirectional or unidirectional, 8" or 12" dia.
- Drop-forged dome and cast aluminium lower cover make the fitting sturdy, but lightweight too for ease handling in the field
- Light output practically not affected by heavy rainfall thanks to the shallow channel in front of the prism windows
- O-Ring placed outside the dome to avoid dirt deposits between light and base
- Protection degree: IP68
- Temperature range: -55°C to +55°C

INSTALLATION

- Suitable for 8" or 12" dia. bases
- Adaptor ring for 8" light installation on 12" dia. bases
- Specific tools available for easy and precise installation

PHOTOMETRIC PERFORMANCES

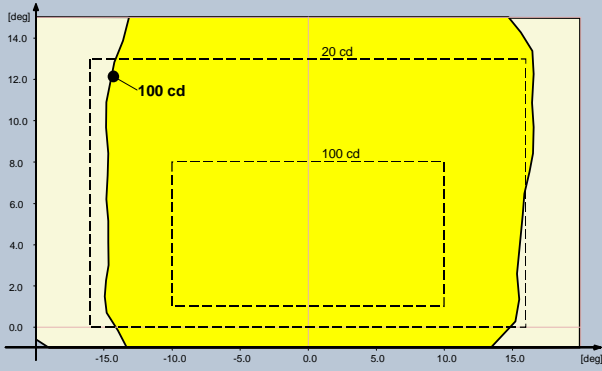

Fig. 1 ICAO A2-12 Straight Section – Yellow

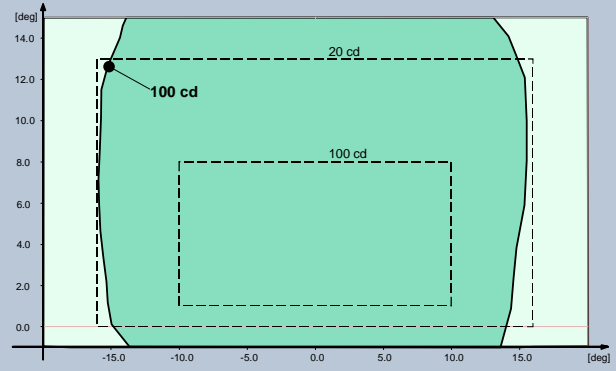

Fig. 2 ICAO A2-12 Straight Section – Green

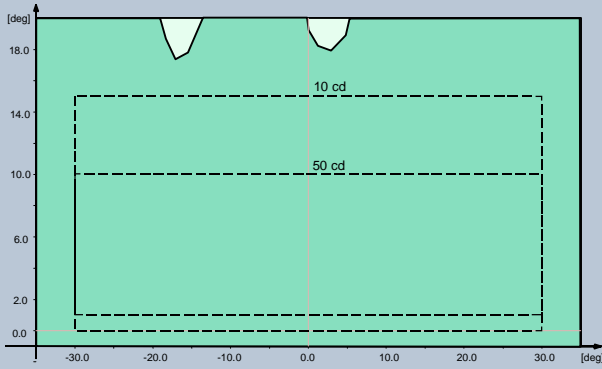

Fig. 3 FAA L-852D – Green

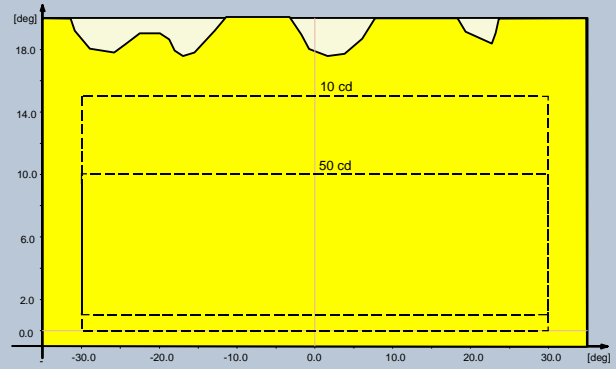

Fig. 4 FAA L-852D – Yellow

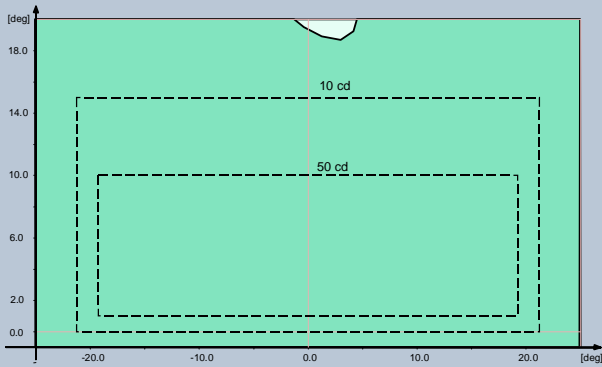

Fig. 5 FAA L-852K – Green

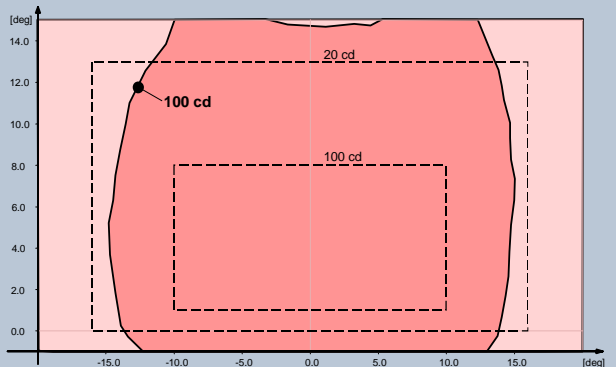

Fig. 6 ICAO A2-12 Straight Section – Red

TABLES

POWER CONSUMPTION*		
Electrical System	1 Plug	2 Plugs
Unidirectional 8"-12" (w/o Arctic Kit)	7 VA	-
Unidirectional 8" (with Arctic Kit)	27 VA	-
Unidirectional 12" (with Arctic Kit)	47 VA	-
Bidirectional 8"-12" (w/o Arctic Kit)	12 VA	14 VA
Bidirectional 8" (with Arctic Kit)	32 VA	54 VA
Bidirectional 12" (with Arctic Kit)	52 VA	94 VA

* Measured at 6.6 A and referred to the highest consumption configuration

POWER FACTOR		
Input Step	2.8 A	6.6 A
Power Factor	0.96	0.98

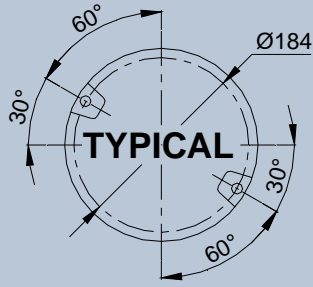

Light Fixture 8" dia.

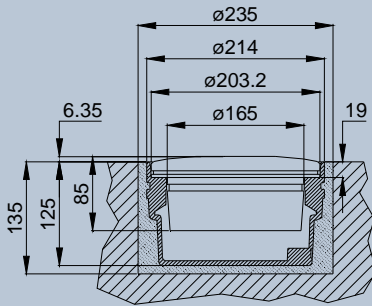

Shallow Base 8" dia.

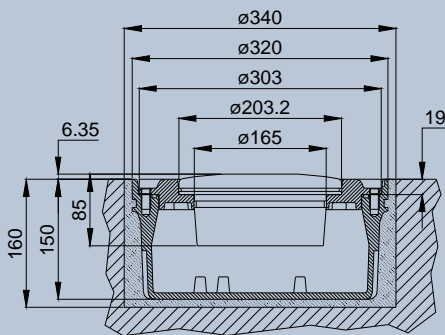

Shallow Base 12" dia.

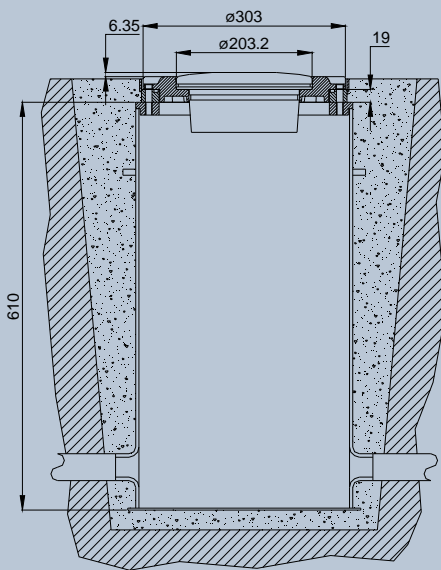

L-868 Deep Base 12" dia.

LITC08 - F - D - GG - 2P - 0 - M - A

Basic P/N: _____
 08 = 8" Fixture
 12 = 12" Fixture

Compliance: _____
 I = ICAO CAT III
 S = ICAO CAT I-II
 F = FAA

Use Code: _____
 (Refer to TABLE A)

Colour (Side A)/(Side B)*: _____
 G = Green
 Y = Yellow
 R = Red (not for FAA)
 M = Blank (unidirectional dome)**

Electrical System: _____
 1P = One Plug
 2P = Two Plugs

Mounting Assembly: _____
 0 = No mounting Assembly
 R = Adaptor Ring 8"-12" dia.

Monitoring: _____
 0 = Without Monitoring
 M = With Monitoring

Arctic Kit: _____
 0 = Without Arctic Kit
 A = With Arctic Kit

TABLE A

USE	I = ICAO CAT III	S = ICAO CAT I-II	F = FAA
A	Fig. A2.12 straight before and after curves	Fig. A2.15 straight	L-852A
B			L-852B
C	Fig. A2.13 straight		L-852C
D			L-852D
W	Fig. A2.14 curved	Fig. A2.16 curved	
K			L-852K
J			L-852J

* For curved sections it's necessary to specify the colour of each side, "A" and "B", due to the fixture toe-in
 ** The aperture not finished "M", on straight sections fixtures, will be always on side "B"

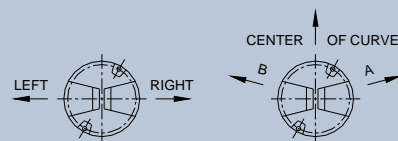

Straight and Curved Section Orientation

RENEWAL PARTS FOR LIGHT UNIT

- 1 Dome
- 2 O-Ring for dome
- 3 O-Ring for lower cover
- 4 Prism Gasket
- 5 Prism
- 6 Prism holder gasket
- 7 Mounting plate
- 8 Lower cover with electronic, plug and valve
- 9 Valve for watertightness test
- 10 Arctic Kit heater
- 11 Arctic Kit thermostat
- 12 LED module with accessories
- 13 Reflector with hardware
- 14 Lower cover gasket
- 15 FAA L-823 plug

Refer to the relevant technical manual for the complete list of the available spare parts

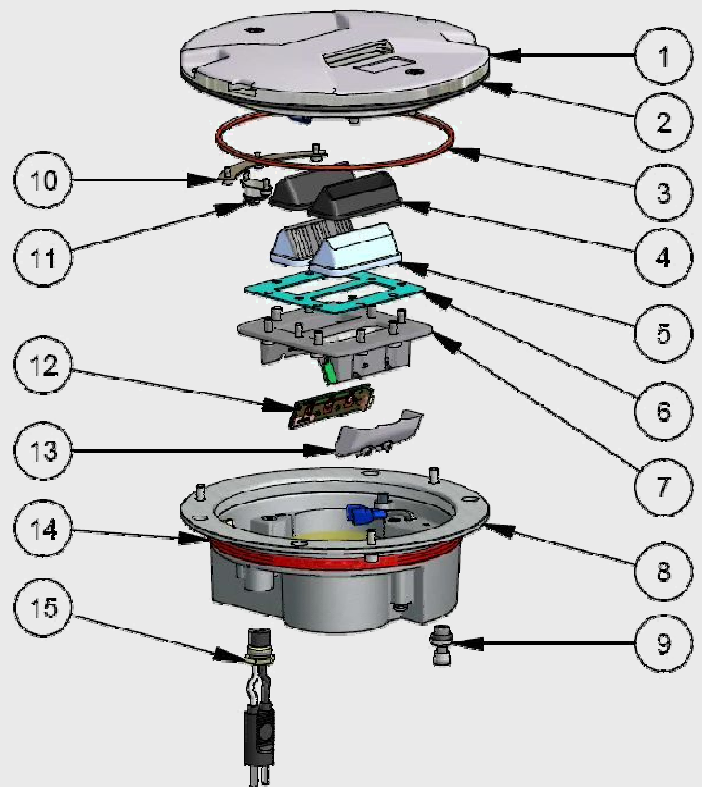
**ACCESSORIES**

- 315.1230 Base L-868 type, class IA, size B, 24" deep *
- 315.1420 Flange ring with pavement dam for L-868 base, size B, with O-Ring and bolts
- 152.5251 Shallow base, 8" dia., one cable lead, with hardware
- 152.5261 Shallow base, 8" dia., two cable leads, with hardware
- 152.8110 Shallow base, 12" dia., one cable lead, with gasket and hardware
- 153.1110 Shallow base, 12" dia., two cable leads, with gasket and hardware
- 152.6116 Adaptor Ring 8"-12" dia. complete with hardware
- 712.1034 Setting material for shallow base, 10 lt
- 712.1035 Quartz for shallow base, 25 kg
- 332.4301 Positioning jig for 8"-12" dia. shallow base, without optical device
- 332.4351 Optical device for positioning jig to allow a very precise light unit orientation
- 332.4330 Watertight/shockproof plastic case complete with positioning jig for base and optical device
- 332.4140 Lifting tool (2 pieces to work properly)

* Sectional bases may be required depending upon the paving technique

For any information about isolating transformers and connectors, please see the specific catalogue pages

8" Shipping Weights and Volumes

	Light Unit	Shallow Base	Light Unit & Adaptor Ring
Weight (kg)	3.6	3.2	6.75
Volume (m³)	0.007	0.007	0.013

12" Shipping Weights and Volumes

	Light Unit	Shallow Base
Weight (kg)	5.9	7.3
Volume (m³)	0.022	0.022